

LMR

Alarm lamp monitor

LMR (Lamp Monitor Relay) monitors consistently the current that flows through a warning lamp. When using warning lamp in application such as antenna tower, High rise building, air ports etc, it is important to maintain properly activity of the warning lamps. By monitoring the current flow through the lamp, the LMR indicates if the lamp is lit or not. When the lamp is lit the output relay energizes. The relay disconnects if the lamp fail to work or the supply voltage has been removed from the device.



General specifications

- Main Standards: IEC 61812-1, IEC 61000-6-2, EN 50178
- Additional standards: IEC 61000-4-2, IEC 61000-4-3, IEC 61000-4-4, IEC 61000-4-5
- Protection class open air: IP20
- Self-extinguishing plastic housing UL V0 acc IEC 529
- Mounting position: on DIN-rail TS 35 according to EN 50022
- Mounting position: vertically
- Monitoring current: 80mA - 1.5A
- Load: ≤200W
- Terminal : acc IEC 60947-7-1, IEC 60998-1
- Terminal Capacity: 1x4mm² without multicore cable end
1x0.5 to 2.5mm² with/without multicore cable end

Connections

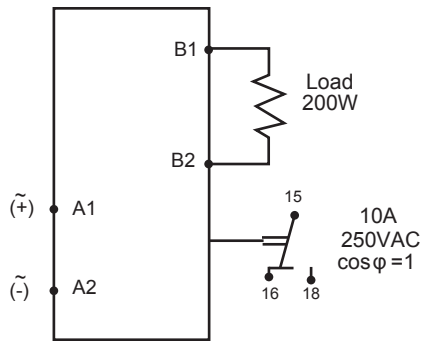

Function

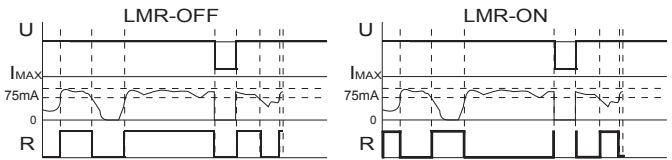

Dimensions

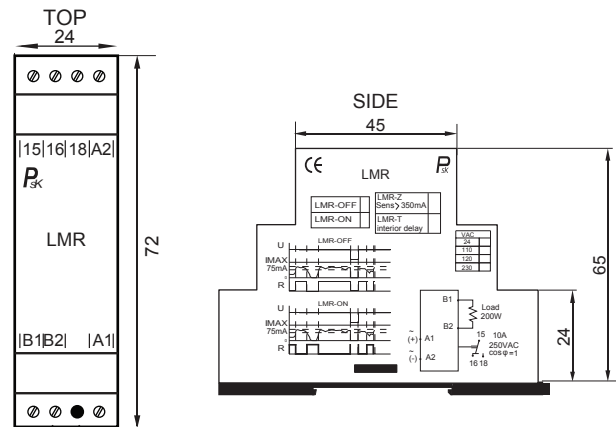

Incoming supply circuit

- Supply voltage: 230VAC
- Supply tolerance: ± 10%
- Incoming Supply terminals: A1 (+) – A2 refer to table below.
- Rated power consumption: 1 VA
- Rated frequency for as voltage: 48 to 63 Hz
- Duty cycle: 100%
- Reset time: 30 ms
- Drop off voltage: ≥ 20% of nominal voltage.

Output circuit

- Relay: 1 C/O
- Rated voltage: 250 Vac
- Switching capacity ac: 1000 VA (8A / 250V) COS φ = 1
- Switching capacity dc: 6 A 30 Vdc
- Max switching capacity ac: 10 A
- Mechanical life: 1 x 10⁶ operations
- Electrical life at 1000 VA COS φ =1: 200.000 operations

Environmental conditions

- Permissible ambient temperature: -25°C....+55°C
- Storage temperature: -25°C....+70°C
- Transport temperature: -25°C....+70°C
- Relative humidity (acc. IEC 721-3-3 CLASS 3K3): 15% to 85%
- Vibration resistance (acc. IEC 68-2-6): 10 TO 55 H

Dimensions & weight

- Width: 24 mm
- Height: 72 mm
- Depth (excl. DIN-profile): 65 mm
- Weight: 74 gram

Ordering information

LMR — V

VAC		
24		
110		
120		
230		

Supply Voltage